

BIRDIE INSERT ANCHORS

HIGH PERFORMANCE ADHESIVE SYSTEMS FOR HOLLOW BASE MATERIAL & TERRACOTTA

CERTIFICATION

TECHNICAL DATA

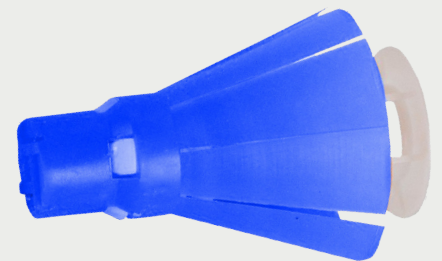

FOR INSTALL SUPPORT

sales@allfasteners.com



FOR SPECIFICATION SUPPORT

certs@allfasteners.com



FOR CUSTOMER SUPPORT

888.859.6060



BIRDIE INSERT ANCHORS

HIGH PERFORMANCE ADHESIVE SYSTEMS FOR HOLLOW BASE MATERIAL & TERRACOTTA

HBB Birdie Insert Anchors — specially designed for fastening to the face of hollow concrete block, brick, clay tile or terracotta. Accepts 1/4", 3/8" and 1/2" adhesive anchor rod. This anchor gives a large bearing surface inside the block, providing consistent high load capacity.

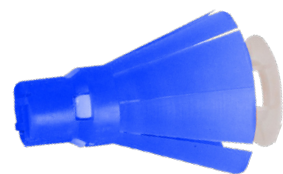

DESCRIPTION & ADVANTAGES

HBB BIRDIE INSERT ANCHOR WITH VF200PRO ADHESIVE

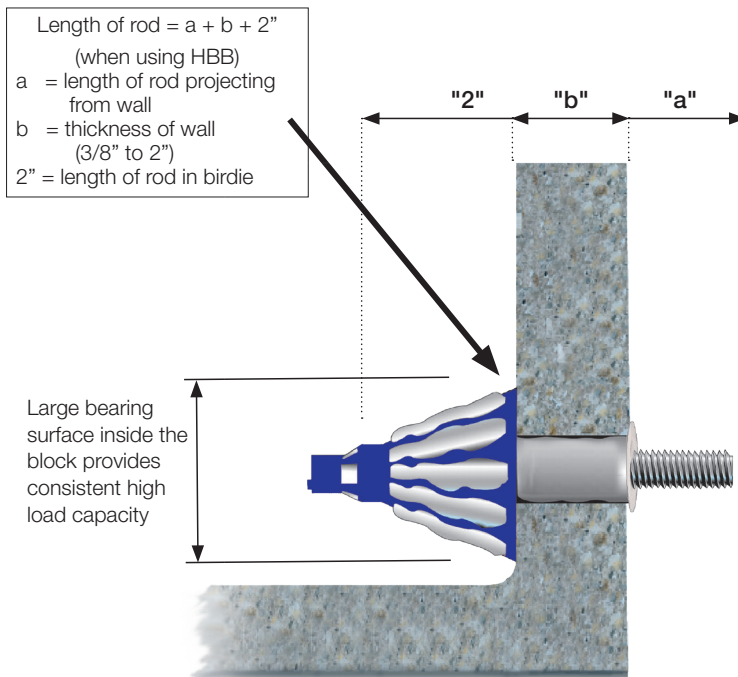

(Rods nuts and washer sold separately)



Use with ICC Evaluated VF200PRO Adhesive Anchor



BIRDIE INSERT ANCHORS

HIGH PERFORMANCE ADHESIVE SYSTEMS FOR HOLLOW BASE MATERIAL & TERRACOTTA

INSTALLATION INSTRUCTIONS

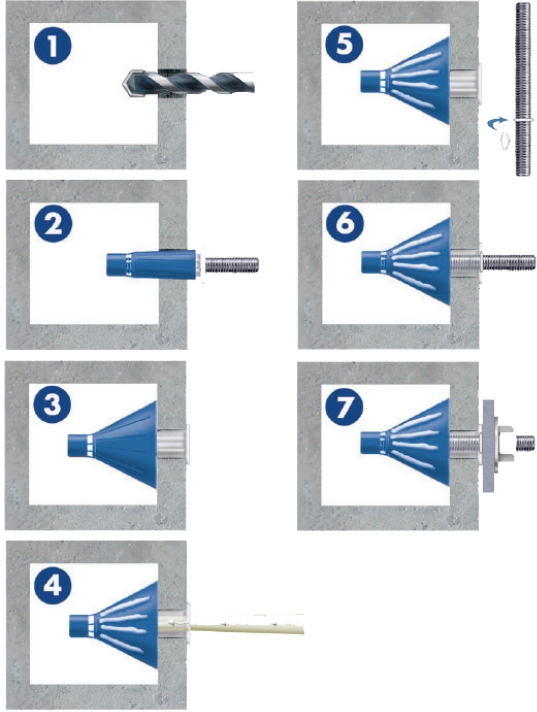

1. Drill 3/4" diameter hole, 3-3/4" deep using rotation only drilling mode and carbide tipped drill bit. Clean out hole with forced air. Complete hole preparation with use of a brush and repeat cleaning with compressed air (leave no dust or slurry).
2. Place birdie on piece of threaded rod, stretch birdie over the rod by pulling the white collar back approximately 1". Squeeze blue portion of birdie and push birdie into hole.
3. Push birdie body through the hole and completely into void. Remove threaded rod. (Do not use in solid base materials. For anchoring into block web, ends and mortar joints, use screens.)
4. Dispense and discard a sufficient amount of adhesive from new cartridge until a uniform adhesive mix is achieved. Inject approximately 1-1/2 fl. oz. of adhesive into birdie (7 to 8) pumps using manual dispenser) to completely fill birdie.
5. 3/8" rod uses a centering ring (supplied with inserts) to keep rod perpendicular to the wall.
6. Insert rod into the filled birdie using a slow, soft twisting motion until it contacts the back of birdie.
7. Wait for appropriate temperature/cure time before tightening fixture to the recommended torque of 10 ft./lbs.

PRODUCT SPECIFICATIONS

TABLE 1: NUMBER OF ANCHORING INSTALLS PER CARTRIDGE* USING THREADED ROD & BIRDIE INSERTS WITH VF200PRO

ROD in. (mm)	DRILL HOLE DIAMETER in.	VOLUME OF CARTRIDGE		BIRDIE INSERT WITH EMBEDMENT OF 3-3/4"
		VF200PRO		
3/8" (9.5)	3/4"		10 Fluid oz.	6
			28 Fluid oz.	17

*These estimates do not account for waste.

TABLE 2: LOAD VALUES^{1,2} - USING VF200PRO IN HOLLOW CONCRETE BLOCK

	ROD DIAMETER		MAX CLAMPING FORCE AFTER PROPER CURE		DRILL HOLE DIAMETER		EMBEDMENT DEPTH		ULTIMATE TENSION		ULTIMATE SHEAR	
	in.	mm	ft.-lbs.	Nm	in.	mm	in.	mm	lbs.	kN	lbs.	kN
Birdie Insert Anchor	3/8	9.5	10	13	3/4	19.1	3-3/4	95.3	3,558	15.8	3,109	13.8

1. Allowable working loads should not exceed 25% ultimate capacity. Based upon testing using ASTM A307 threaded rod. Divide by 4.
2. The tabulated values are for anchors installed at a minimum 12" edge distance and minimum 8" spacing.



BIRDIE INSERT ANCHORS

HIGH PERFORMANCE ADHESIVE SYSTEMS FOR HOLLOW BASE MATERIAL & TERRACOTTA

DIMENSIONAL DATA

TABLE 3: LOAD VALUES - USING VF200PRO IN TERRACOTTA HOLLOW BLOCK

substrate		ROD DIAMETER		DRILL HOLE DIAMETER		EMBEDMENT DEPTH		ULTIMATE TENSION	ALLOWABLE TENSION
		in.	mm	in.	mm	in.	mm	lbs.	lbs.
Birdie Insert Anchor	Bare Terracotta	3/8	9.5	3/4	19.1	3-3/4	95.3	870	217
	Terracotta Block + 3/4"-1" Layer of Plaster	3/8	9.5	3/4	19.1	3-3/4	95.3	1,190	297

Load values based on pull testing in existing terracotta. Job specific pull testing recommended for accurate pull values. Allowable tension values based on safety factor of 4.

ORDERING INFORMATION

TABLE 4: BIRDIE INSERT ANCHOR ORDERING INFORMATION

PART NUMBER	DESCRIPTION	QTY/BOX
1HBB	Terracotta/Hollow Block Birdie Insert Anchor For Use w/ VF200PRO Epoxy	20

TABLE 5: ADHESIVE ANCHOR ROD ZINC ORDERING INFORMATION

PART NUMBER	SIZE	FINISH	QTY/BOX
1SCMZ14400	1/4-20 x 4" Adhesive Anchor Rod Assembly w/ Nut & Washer	Zinc	50
1SCMZ38418	3/8-16 x 4-1/8" Adhesive Anchor Rod Assembly w/ Nut & Washer	Zinc	25
1SCMZ38518	3/8-16 x 5-1/8" Adhesive Anchor Rod Assembly w/ Nut & Washer	Zinc	25
1SCMZ38638	3/8-16 x 6-3/8" Adhesive Anchor Rod Assembly w/ Nut & Washer	Zinc	25
1SCMZ12612	1/2-13 x 6-1/2" Adhesive Anchor Rod Assembly w/ Nut & Washer	Zinc	20

TABLE 6: ADHESIVE ANCHOR ROD HOT DIP GALVANIZED ORDERING INFORMATION

PART NUMBER	SIZE	FINISH	QTY/BOX
1SCMG38418	3/8-16 x 4-1/8" Adhesive Anchor Rod Assembly w/ Nut & Washer	Hot Dip Galvanized	25
1SCMG38518	3/8-16 x 5-1/8" Adhesive Anchor Rod Assembly w/ Nut & Washer	Hot Dip Galvanized	25
1SCMG38638	3/8-16 x 6-3/8" Adhesive Anchor Rod Assembly w/ Nut & Washer	Hot Dip Galvanized	25
1SCMG12612	1/2-13 x 6-1/2" Adhesive Anchor Rod Assembly w/ Nut & Washer	Hot Dip Galvanized	20

TABLE 7: ADHESIVE ANCHOR ROD 316 STAINLESS STEEL ORDERING INFORMATION

PART NUMBER	SIZE	FINISH	QTY/BOX
1SCMS38418	3/8-16 x 4-1/8" Adhesive Anchor Rod Assembly w/ Nut & Washer	316 Stainless Steel	25
1SCMS38518	3/8-16 x 5-1/8" Adhesive Anchor Rod Assembly w/ Nut & Washer	316 Stainless Steel	25
1SCMS38638	3/8-16 x 6-3/8" Adhesive Anchor Rod Assembly w/ Nut & Washer	316 Stainless Steel	25
1SCMS12612	1/2-13 x 6-1/2" Adhesive Anchor Rod Assembly w/ Nut & Washer	316 Stainless Steel	20

TABLE 8: VF200PRO ORDERING INFORMATION

PART NUMBER	DESCRIPTION	SIZE	QTY/BOX
1VF200PRO	VF200PRO Epoxy w/ Mixing Nozzle	10oz	1
1VF200PRO-28	VF200PRO Epoxy w/ Mixing Nozzle	28oz	1