

# DA STANDARD & DA-LP LIPPED DROP-IN ANCHORS

ZINC PLATED & STAINLESS STEEL

CERTIFICATION

TECHNICAL DATA



**FOR INSTALL SUPPORT**  
[sales@allfasteners.com](mailto:sales@allfasteners.com)



**FOR SPECIFICATION SUPPORT**  
[certs@allfasteners.com](mailto:certs@allfasteners.com)



**FOR CUSTOMER SUPPORT**  
888.859.6060



# DA STANDARD & DA-LP LIPPED DROP-IN ANCHORS

ZINC PLATED &amp; STAINLESS STEEL

**Drop-In Anchors** are used in medium to heavy duty applications in solid mediums such as concrete and stone. A flush internal threaded anchor, the drop-in houses an internal plug which is held securely in place even when used in overhead applications. Drop-ins are frequently used for overhead applications, including hanging pipe, duct work, machinery, fire sprinkler, conduit, concrete form work, etc.



## KEY BENEFITS

- Internally threaded for easy bolt removal and service work
- Lipped version installs flush for easy inspection and consistent embedment
- Standard drop-in can be installed flush mounted or below the base material surface
- Knurled body increases vibration resistance and prevents anchor from sliding out
- Coil thread option available for concrete formwork applications

## INSTALLATION INSTRUCTIONS

### STANDARD INSTALLATION

1. Drill a hole to the recommended diameter and depth using the fixture as a template.
2. Clean the hole thoroughly removing debris with a hand pump, compressed air, or vacuum.
3. Insert drop-in anchor with thread opening facing out, and tap until fully seated in the hole
4. Using the correct setting tool, set the anchor by placing the tool into the anchor until the tool is seated. Hammer in the anchor until the tool is seated. Hammer in the anchor with 1 to 2 firm hits.
5. Remove setting tool, place fixture, insert bolt or thread rod and tighten. Don't over tighten the anchor as it is already expanded.

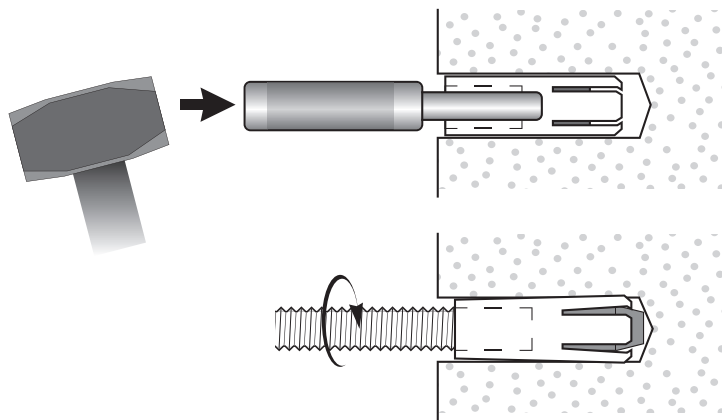

### LIPPED INSTALLATION

1. Drill a hole to the recommended diameter and depth using the fixture as a template.
2. Clean the hole thoroughly removing debris with a hand pump, compressed air, or vacuum.
3. Insert drop-in anchor with thread opening facing out, and tap until fully seated in the hole
4. Using the correct setting tool, set the anchor by placing the tool into the anchor until the tool is seated. Hammer in the anchor with 1 to 2 firm hits.
5. Remove setting tool, place fixture, insert bolt or thread rod and tighten. Don't over tighten the anchor as it is already expanded.

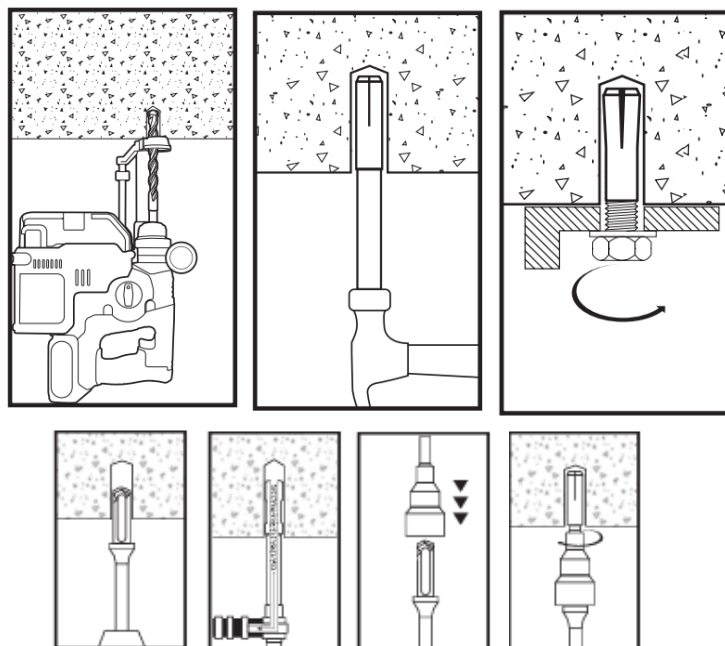



# DA STANDARD & DA-LP LIPPED DROP-IN ANCHORS

ZINC PLATED & STAINLESS STEEL

## PRODUCT SPECIFICATIONS

**TABLE 1: ULTIMATE TENSION & SHEAR VALUES (LBS/kN) IN SOLID CONCRETE**

BOLT DIAMETER in. (mm)	ANCHOR DIAMETER in. (mm)	MIN. EMBEDMENT DEPTH in. (mm)	ANCHOR TYPE	TENSION lbs. (kN)			SHEAR lbs. (kN)
				f'c=2,000 psi (13.8 MPa)	f'c=4,000 psi (27.6 MPa)	f'c=6,000 psi (41.4 MPa)	f'c=2,000 psi (13.8 MPa)
1/4" (6.4)	3/8" (9.5)	1" (25.4)	Standard, Lipped & Stainless Steel	1,680 (7.5)	2,360 (10.5)	2,980 (13.3)	1,080 (4.8)
3/8" (9.5)	1/2" (12.7)	1-5/8" (41.3)		2,980 (13.3)	3,800 (16.9)	6,240 (27.8)	3,160 (14.1)
1/2" (12.7)	5/8" (15.9)	2" (50.8)		3,300 (14.7)	5,840 (26.0)	8,300 (36.9)	4,580 (20.4)
5/8" (15.9)	7/8" (22.2)	2-1/2" (63.5)		5,500 (24.5)	8,640 (38.4)	11,020 (49.0)	7,440 (33.1)
3/4" (19.1)	1" (25.4)	3-3/16" (81.0)		8,280 (36.8)	9,480 (42.2)	12,260 (54.5)	10,480 (46.6)

**TABLE 2: ALLOWABLE TENSION & SHEAR VALUES (LBS/kN) IN SOLID CONCRETE**

BOLT DIAMETER in. (mm)	ANCHOR DIAMETER in. (mm)	MIN. EMBEDMENT DEPTH in. (mm)	ANCHOR TYPE	TENSION lbs. (kN)			SHEAR lbs. (kN)
				f'c=2,000 psi (13.8 MPa)	f'c=4,000 psi (27.6 MPa)	f'c=6,000 psi (41.4 MPa)	f'c=2,000 psi (13.8 MPa)
1/4" (6.4)	3/8" (9.5)	1" (25.4)	Standard, Lipped & Stainless Steel	420 (1.9)	590 (2.6)	745 (3.3)	270 (1.2)
3/8" (9.5)	1/2" (12.7)	1-5/8" (41.3)		745 (3.3)	950 (4.2)	1,560 (7.0)	790 (3.5)
1/2" (12.7)	5/8" (15.9)	2" (50.8)		825 (3.7)	1,460 (6.5)	2,075 (9.2)	1,145 (5.1)
5/8" (15.9)	7/8" (22.2)	2-1/2" (63.5)		1,375 (6.1)	2,160 (9.6)	2,755 (12.2)	1,860 (8.3)
3/4" (19.1)	1" (25.4)	3-3/16" (81.0)		2,070 (9.2)	2,370 (10.6)	3,065 (13.6)	2,620 (11.7)

**TABLE 3: RECOMMENDED EDGE & SPACING DISTANCE REQUIREMENTS**

BOLT DIAMETER in. (mm)	ANCHOR DIAMETER in. (mm)	EMBEDMENT DEPTH in. (mm)	EDGE DISTANCE REQUIRED TO OBTAIN MAX. WORKING LOAD in. (mm)	MIN. EDGE DISTANCE AT WHICH LOAD FACTOR APPLIED = .80 FOR TENSION =.70 FOR SHEAR in. (mm)	SPACING REQUIRED TO OBTAIN MAX. WORKING LOAD in. (mm)	MIN. ALLOWABLE SPACING BETWEEN LOAD FACTOR APPLIED = .80 FOR TENSION =.55 FOR SHEAR in. (mm)
1/4" (6.4)	3/8" (9.5)	1" (25.4)	1-3/4" (44.5)	7/8" (22.2)	3-1/2" (88.9)	1-3/4" (44.5)
3/8" (9.5)	1/2" (12.7)	1-5/8" (41.3)	2-7/8" (73.0)	1-7/16" (36.5)	5-11/16" (144.5)	2-7/8" (73.0)
1/2" (12.7)	5/8" (15.9)	2" (50.8)	3-1/2" (88.9)	1-3/4" (44.5)	7" (177.8)	3-1/2" (88.9)
5/8" (15.9)	7/8" (22.2)	2-1/2" (63.5)	4-3/8" (111.1)	2-3/16" (55.6)	8-3/4" (222.3)	4-3/8" (111.1)
3/4" (19.1)	1" (25.4)	3-3/16" (81.0)	5-5/8" (142.9)	2-13/16" (71.4)	11-13/16" (284.2)	5-5/8" (142.9)



**DA STANDARD & DA-LP LIPPED DROP-IN ANCHORS**  
ZINC PLATED & STAINLESS STEEL

**ORDERING INFORMATION**



**TABLE 4: DAZ STANDARD DROP-IN ANCHOR ZINC PLATED ORDERING INFORMATION**

PART NUMBER	SIZE	DRILL SIZE	QTY/BOX
1DAZ14	1/4 x 1"	3/8"	100
1DAZ38	3/8 x 1-9/16"	1/2"	50
1DAZ12	1/2 x 2"	5/8"	50
1DAZ58	5/8 x 2-1/2"	7/8"	25
1DAZ34	3/4 x 3"	1"	25

**TABLE 5: DAS2 STANDARD DROP-IN ANCHOR STAINLESS STEEL ORDERING INFORMATION**

PART NUMBER	SIZE	DRILL SIZE	QTY/BOX
1DAS214	1/4 x 1"	3/8"	100
1DAS238	3/8 x 1-9/16"	1/2"	50
1DAS212	1/2 x 2"	5/8"	50
1DAS258	5/8 x 2-1/2"	7/8"	25
1DAS234	3/4 x 3"	1"	25



**TABLE 6: DA-LP LIPPED DROP-IN ANCHOR ZINC PLATED ORDERING INFORMATION**

PART NUMBER	SIZE	DRILL SIZE	QTY/BOX
1DAZ38LP	3/8 x 1-9/16"	1/2"	50
1DAZ12LP	1/2 x 2"	5/8"	50



**TABLE 7: QUICK SDS-PLUS DROP-IN SETTING TOOL ORDERING INFORMATION**

PART NUMBER	SIZE	QTY/BOX
1DT38	3/8" Quick SDS-Plus Drop-In Setting Tool	1
1DT12	1/2" Quick SDS-Plus Drop-In Setting Tool	1



**TABLE 8: QUICK SDS-PLUS DROP-IN DRILL BIT ORDERING INFORMATION**

PART NUMBER	SIZE	QTY/BOX
1DTB38	3/8" Quick SDS-Plus Drop-In Drill Bit	1
1DTG12	1/2" Quick SDS-Plus Drop-In Drill Bit	1