

# <sup>®</sup>**A** NEXSPAN2™ F SERIES SUBMITTAL PACKAGE FOR MEP EQUIPMENT PLATFORMS

2	Introduction
3	T-Bolts & Slots
4-6	Application Examples
7-9	Ordering Information
10-11	Technical Specifications



## OVERVIEW & INFORMATION

Allfasteners NexSpan2™ F Series is changing the game as modern contractors seek to simplify the design, fabrication, and installation of MEP equipment platforms and other steel structures.

NexSpan2 F Series' pre-engineered, modular design paired with the patent pending NexSpan2 T-Bolt and a complete range of connectors, provide an effortless framing system, eliminating the need for site welding and heavy cranes.



## APPLICATIONS

### ▪ Data Centers

- Floor/Roof Mounted MEP Equipment Platforms
- Walkable Ceiling Structures
- Raised Floor Structures
- Chiller Piping Stands/Racks
- Multi-Level Trapeze Supports
- Transformer Platforms
- Tank/Pump Skids

### ▪ Hospitals

- Floor/Roof Mounted MEP Equipment Platforms
- HVAC Equipment Stands (VRF)
- Medical Gas Piping Stanchions

### ▪ Airports

- Floor/Roof Mounted MEP Equipment Platforms
- HVAC Equipment Stands (VRF)
- Chiller Piping Stanchions

### ▪ Water/Waste Treatment Plants

- Adjustable Pipe Stanchions
- Pump Stations
- Multi-Level Pipe Racks

### ▪ For Installing in Challenging Environments

## KEY BENEFITS

- Similar loading properties to welded steel frames
- No on-site welding needed
- Reduced need for crane work and heavy lifting equipment
- Easy adjustment/leveling
- Well suited for installation in challenging environments
- Rapidly assemble with only an impact driver or torque wrench
- Compact packaging allows for simple transport
- Cost effective compared to welding structural steel
- T-Bolts feature a slot in the shank end, indicating correct installation
- Hot Dip Galvanized
- Made in the USA



## MODULAR DESIGN FOR FAST INSTALLATION

Allfasteners' NexSpan2™ F Series offers unparalleled efficiency, durability, and adaptability, making it the optimal choice for contractors operating in dynamic environments.

With its modular design, rapid installation process, and ability to support heavy loads, contractors can confidently rely on NexSpan2™ to meet the rigorous demands of modern construction projects, such as data centers, hospitals, waste/water treatment plants, and airports ensuring both quality and efficiency from start to finish.

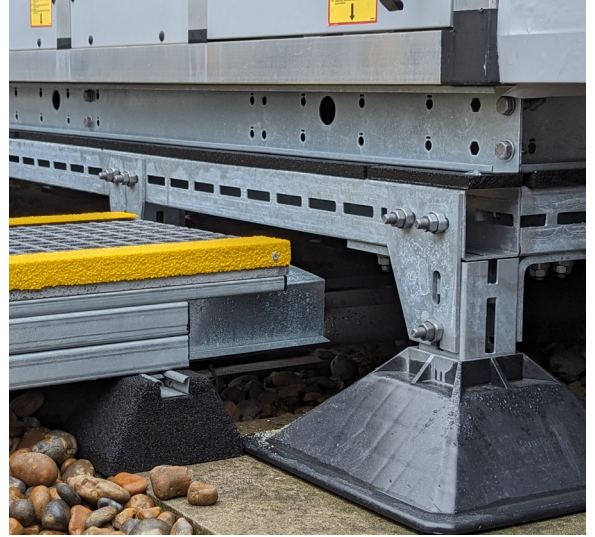

## T-BOLT & SLOTS

The NexSpan2™ F Series implements a unique M12 T-bolt made from 10.9 high grade steel up to 2,200 lbs load resistance. Paired with the NexSpan2's slot design, the T-bolt makes leveling frames and structures simple and fast - where traditional screw systems require precise alignment of holes.





APPLICATION EXAMPLES





APPLICATION EXAMPLES

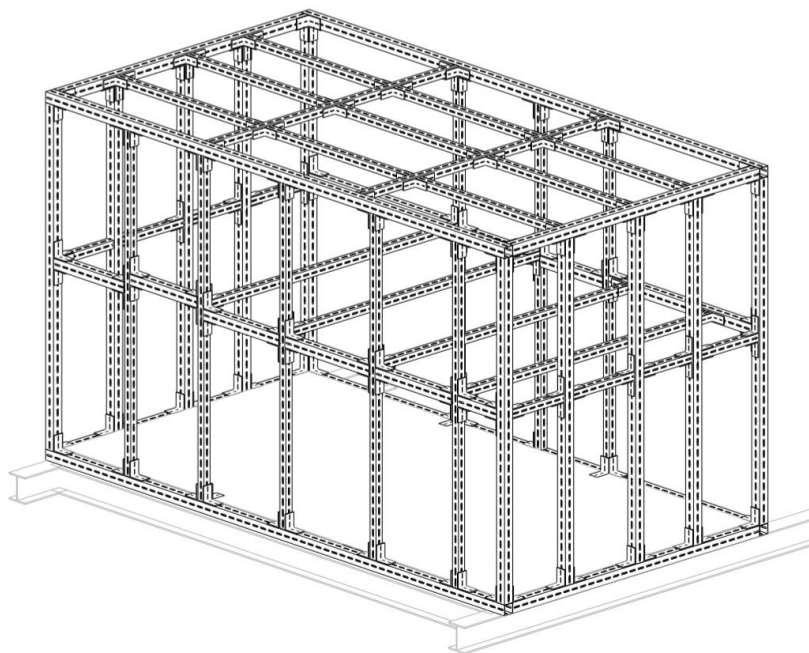

APPLICATION EXAMPLES

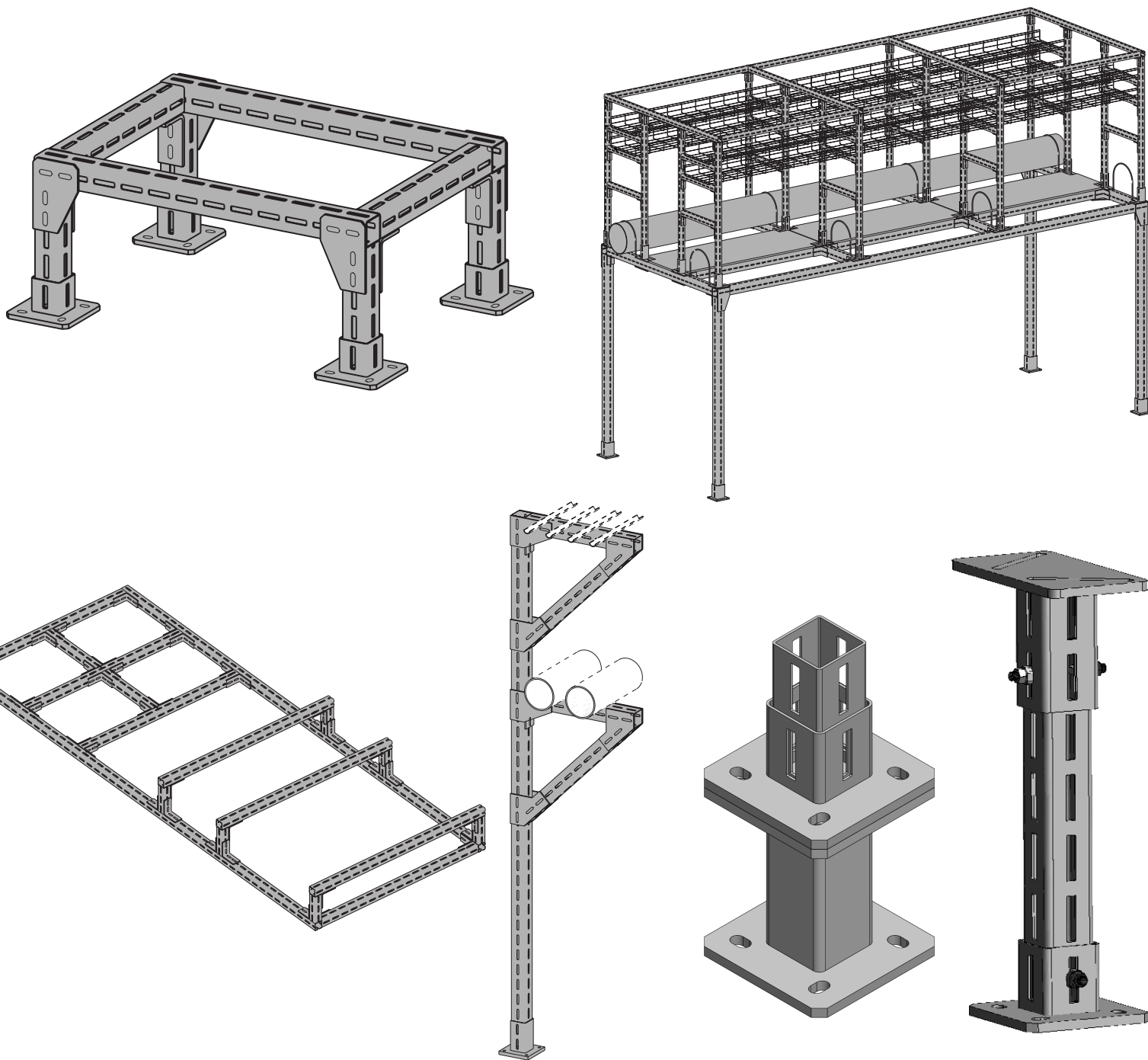

### ORDERING INFORMATION

**TABLE 1: NEXSPAN2™ F SERIES ORDERING INFORMATION**



PART #	SIZE	LENGTH	SLOT WIDTH
14NSF310	3 x 3 x 1/8"	10'	0.5625"
14NSF320	3 x 3 x 1/8"	20'	0.5625"
14NSF410	4 x 4 x 1/8"	10'	0.5625"
14NSF420	4 x 4 x 1/8"	20'	0.5625"

**TABLE 2: NEXSPAN2™ END CAP ORDERING INFORMATION**

PART #	NEXSPAN2 SIZE	FITS PART #
14NSF-EC3	3"	14NSF310 & 14NSF320
14NSF-EC4	4"	14NSF410 & 14NSF420

**TABLE 3: NEXSPAN2™ T-BOLT ORDERING INFORMATION**

PART #	NEXSPAN2 SIZE	FITS PART #
2TLB1240	M12 x 40MM T-Lock Bolt	All F Series
2TLL1240	M12 x 40MM Flat Collar Washer T-Lock Bolt	All F Series



**TABLE 4: NEXSPAN2™ SPLICE CONNECTOR ORDERING INFORMATION**

PART #	NEXSPAN2 SIZE	FITS PART #
14NSF-S13	3"	14NSF310 & 14NSF320
14NSF-S14	4"	14NSF410 & 14NSF420

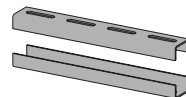

**TABLE 5: NEXSPAN2™ ANGLE ORDERING INFORMATION**

PART #	THICKNESS	NEXSPAN2 SIZE	FITS PART #
14NSF-A63	1/4"	3"	14NSF310 & 14NSF320
14NSF-A64	1/4"	4"	14NSF410 & 14NSF420

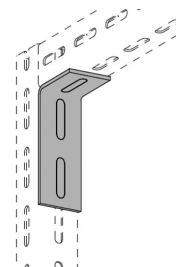

**TABLE 6: NEXSPAN2™ ANGLE ORDERING INFORMATION**

PART #	THICKNESS	NEXSPAN2 SIZE	FITS PART #
14NSF-A73	1/4"	3"	14NSF310 & 14NSF320
14NSF-A74	1/4"	4"	14NSF410 & 14NSF420

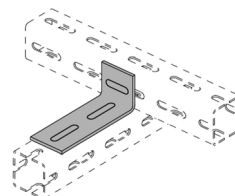

### ORDERING INFORMATION

**TABLE 7: NEXSPAN2™ ANGLE ORDERING INFORMATION**

PART #	THICKNESS	NEXSPAN2 SIZE	FITS PART #
14NSF-A83	1/4"	3"	14NSF310 & 14NSF320
14NSF-A84	1/4"	4"	14NSF410 & 14NSF420

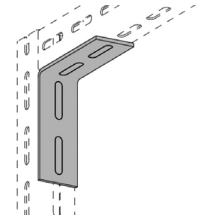

**TABLE 8: NEXSPAN2™ ANGLE ORDERING INFORMATION**

PART #	THICKNESS	NEXSPAN2 SIZE	FITS PART #
14NSF-A93	1/4"	3"	14NSF310 & 14NSF320
14NSF-A94	1/4"	4"	14NSF410 & 14NSF420

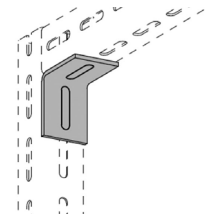

**TABLE 9: NEXSPAN2™ POST BASE ORDERING INFORMATION**

PART #	BOTTOM PLATE THICKNESS	NEXSPAN2 SIZE	FITS PART #
14NSF-B13	5/8"	3"	14NSF310 & 14NSF320
14NSF-B14	5/8"	4"	14NSF410 & 14NSF420

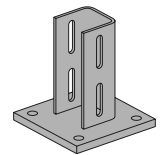

**TABLE 10: NEXSPAN2™ POST BASE ORDERING INFORMATION**

PART #	BOTTOM PLATE THICKNESS	NEXSPAN2 SIZE	FITS PART #
14NSF-B23 (Default Base)	3/8"	3"	14NSF310 & 14NSF320
14NSF-B24 (Default Base)	3/8"	4"	14NSF410 & 14NSF420

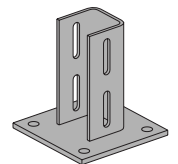

**TABLE 11: NEXSPAN2™ POST BASE ORDERING INFORMATION**

PART #	BOTTOM PLATE THICKNESS	NEXSPAN2 SIZE	FITS PART #
14NSF-B33	1/4" Steel Only	3"	14NSF310 & 14NSF320
14NSF-B34	1/4" Steel Only	4"	14NSF410 & 14NSF420

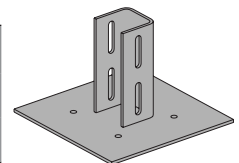

**TABLE 12: NEXSPAN2™ PIPE SUPPORT BRACKET ORDERING INFORMATION**

PART #	FITS PIPE SIZE	FITS PART #
14NSF-PS1	1/2" to 2-1/2" Pipe	All F Series
14NSF-PS2	3" to 8" Pipe	All F Series

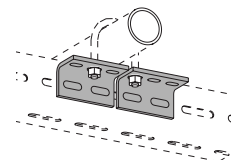



### ORDERING INFORMATION

**TABLE 13: NEXSPAN2™ PLATE ORDERING INFORMATION**

PART #	THICKNESS	NEXSPAN2 SIZE	FITS PART #
14NSF-P63	1/4"	3"	14NSF310 & 14NSF320
14NSF-P64	1/4"	4"	14NSF410 & 14NSF420

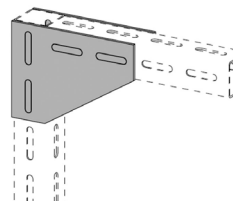

**TABLE 14: NEXSPAN2™ PLATE ORDERING INFORMATION**

PART #	THICKNESS	NEXSPAN2 SIZE	FITS PART #
14NSF-P73	1/4"	3"	14NSF310 & 14NSF320
14NSF-P74	1/4"	4"	14NSF410 & 14NSF420

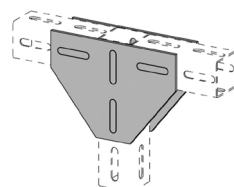

**TABLE 15: NEXSPAN2™ PLATE ORDERING INFORMATION**

PART #	THICKNESS	NEXSPAN2 SIZE	FITS PART #
14NSF-P83	1/4"	3"	14NSF310 & 14NSF320
14NSF-P84	1/4"	4"	14NSF410 & 14NSF420

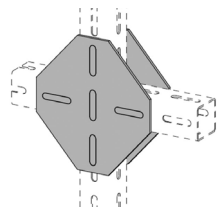

**TABLE 16: NEXSPAN2™ PLATE ORDERING INFORMATION**

PART #	THICKNESS	NEXSPAN2 SIZE	FITS PART #
14NSF-P93	1/4"	3"	14NSF310 & 14NSF320
14NSF-P94	1/4"	4"	14NSF410 & 14NSF420

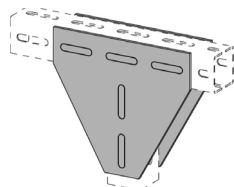

**TABLE 17: NEXSPAN2™ PLATE ORDERING INFORMATION**

PART #	THICKNESS	NEXSPAN2 SIZE	FITS PART #
14NSF-P03	1/4"	3"	14NSF310 & 14NSF320
14NSF-P04	1/4"	4"	14NSF410 & 14NSF420

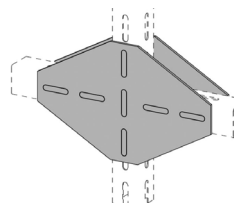

## TECHNICAL SPECIFICATIONS

**TABLE 18: MEMBER PROPERTIES**

	UNITS	14NSF3	14NSF4
Depth	in	3.000	4.000
Width	in	3.000	4.000
Thickness	in	0.125	0.125
Wt/ft.	lb/ft	4.4	6.0

**TABLE 19: SLOT DIMENSIONS**

	UNITS	14NSF3	14NSF4
Height x Width	in.	9/16" x 2-3/4"	9/16" x 2-3/4"

**TABLE 20: MATERIAL INFORMATION**

	UNITS	14NSF3	14NSF4
ASTM Specification		A500 Gr B	A500 Gr B
Minimum Specified Yield Strength	ksi	46	46
Minimum Specified Tensile Strength	ksi	58	58
Modulus of Elasticity	ksi	29000	29000

**TABLE 21: GROSS SECTION PROPERTIES**

	UNITS	14NSF3	14NSF4
Design Thickness	in	0.116	0.116
Area	in <sup>2</sup>	1.300	1.770
Moment of Inertia	in <sup>4</sup>	1.780	4.400
Radius of Gyration	in	1.170	1.580

**TABLE 22: EFFECTIVE SECTION PROPERTIES**

	UNITS	14NSF3	14NSF4
Effective Area	in <sup>2</sup>	1.043	1.506
Effective Web Area	in <sup>2</sup>	0.458	0.689
Effective Moment of Inertia	in <sup>4</sup>	1.507	3.903
Effective Section Modulus	in <sup>3</sup>	1.005	1.952
Effective Radius of Gyration	in	1.203	1.610



### TECHNICAL SPECIFICATIONS

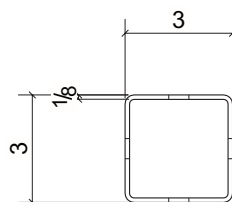

**A - A**

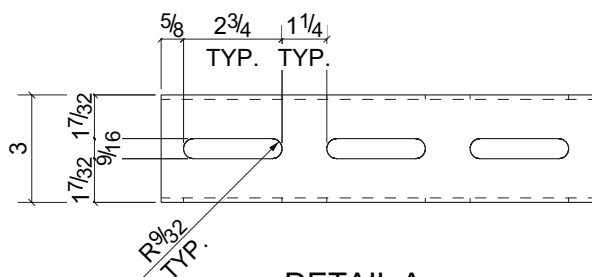

**DETAIL A**  
TYP. @ ALL 4 SIDES

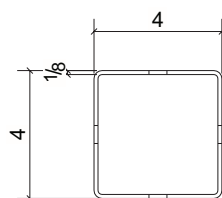
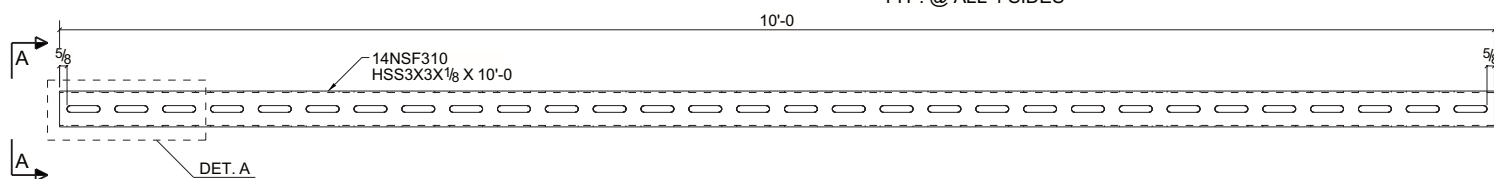

**A - A**

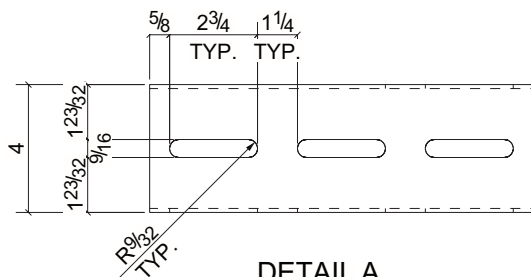

**DETAIL A**  
TYP. @ ALL 4 SIDES

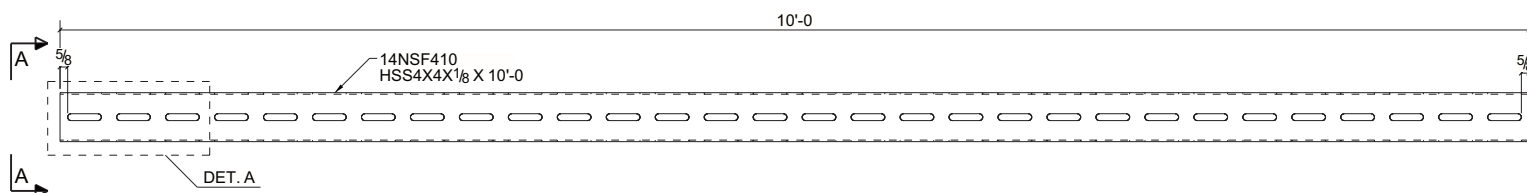

Selection of the product for adequacy should be made by individuals with knowledge of the intended application, locations, loadings, specifications and requirements of the project.

PROJECT INFORMATION		APPROVAL STAMP
PROJECT:		APPROVED
ADDRESS:		APPROVED AS NOTED
CONTRACTOR:		NOT APPROVED
ENGINEER:		REMARKS:
SUBMITTAL DATE:		
NOTES:		







**LOCATIONS NATIONWIDE**

**888.859.6060**

**24/7 ONLINE ORDERING**

**WWW.ALLFASTENERS.COM**